

# HIGHWAY 401 EMERGENCY DETOUR ROUTES

Ministry of Transportation

Eastern Region

2012



# Wallbridge - Loyalist Rd. - Glen Miller Rd.

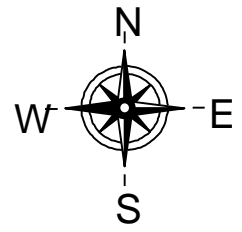

**Belleville**  
→

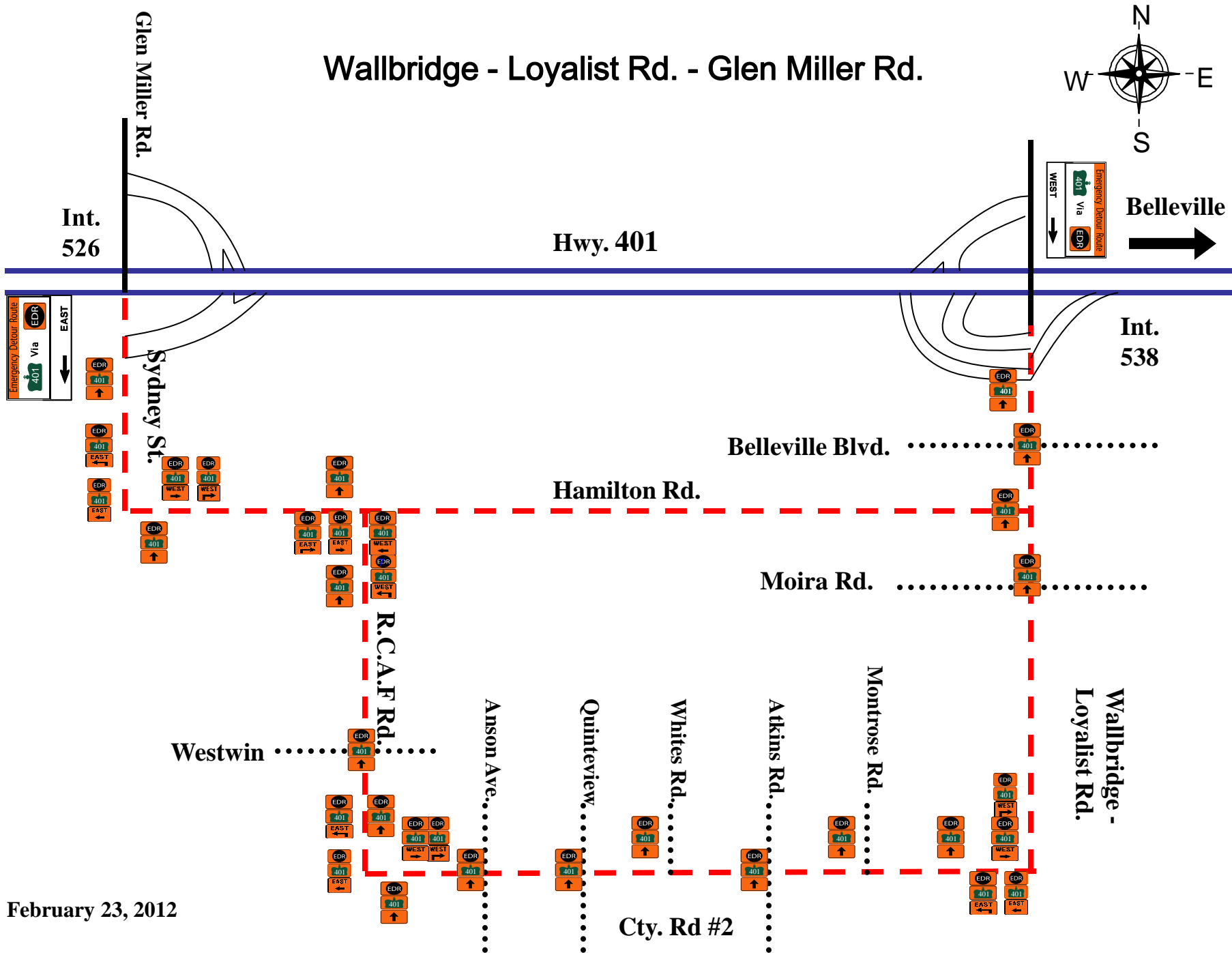

February 23, 2012

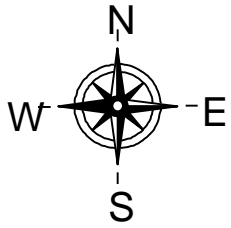

# Glen Miller Rd. - Cty. Rd. 33

Johnstown Rd.

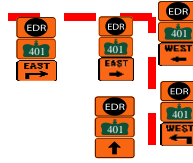
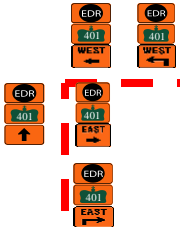

Cty. Rd. 33

Glen Miller Rd.

**NOTE:** Total length of E. B. Detour - 4.43 km  
Reverse Signs for W.B. Direction (N. Off ramp)

Power Rd.....

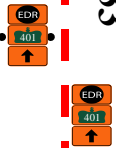

Belleville



Hwy. 401

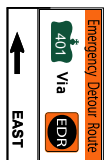

Int. 525

Int. 526

# Cty. Rd. 40 - Cty. Rd. 33 (Wooler Rd.) (formerly Hwy 33)

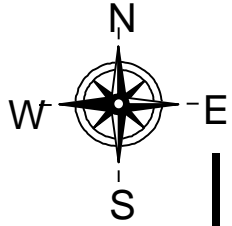

Hwy. 401

Trenton

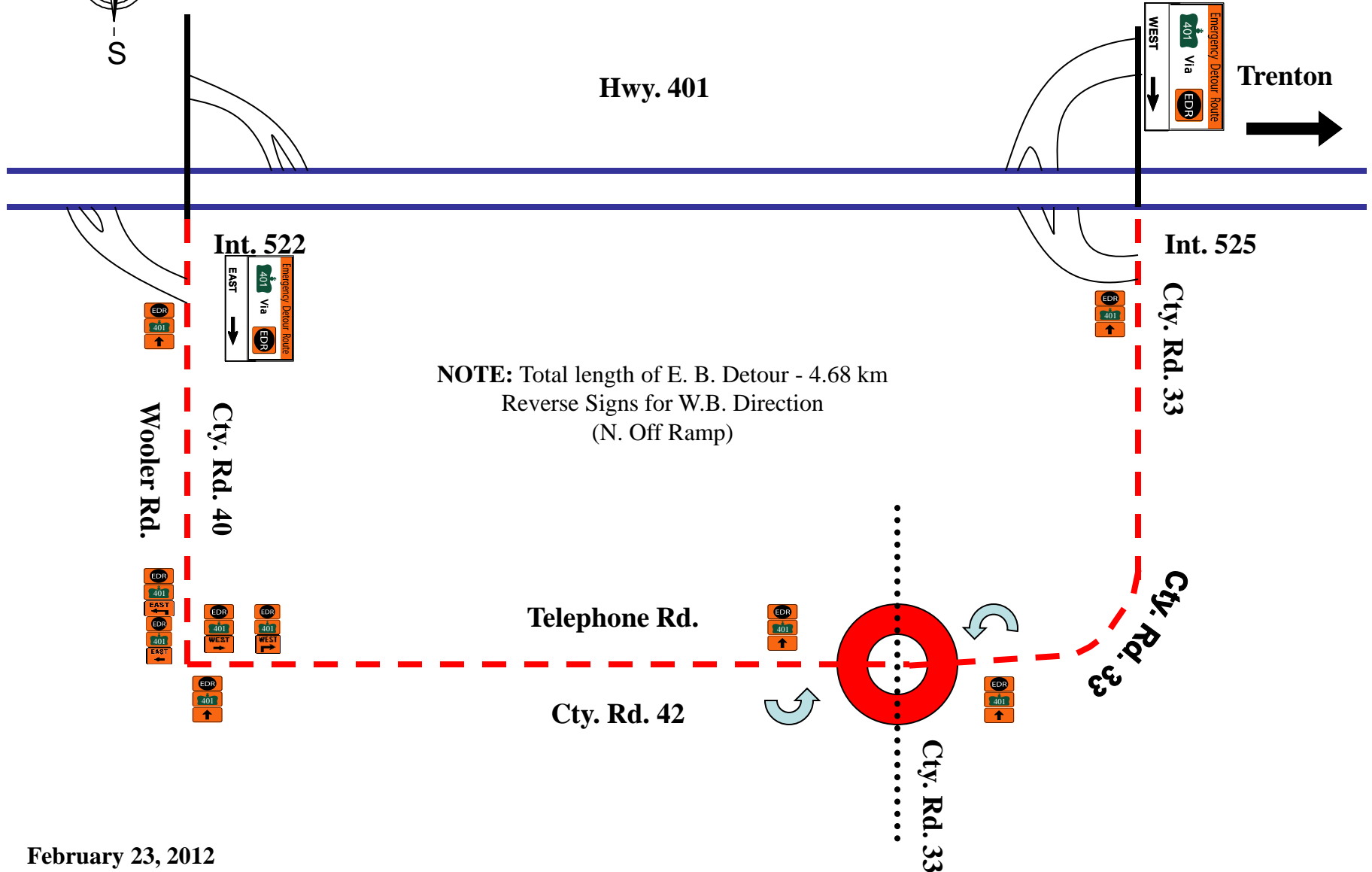

# Cty. Rd. 30 - Cty. Rd. 40 (formerly Hwy 30) (Wooler Rd.)

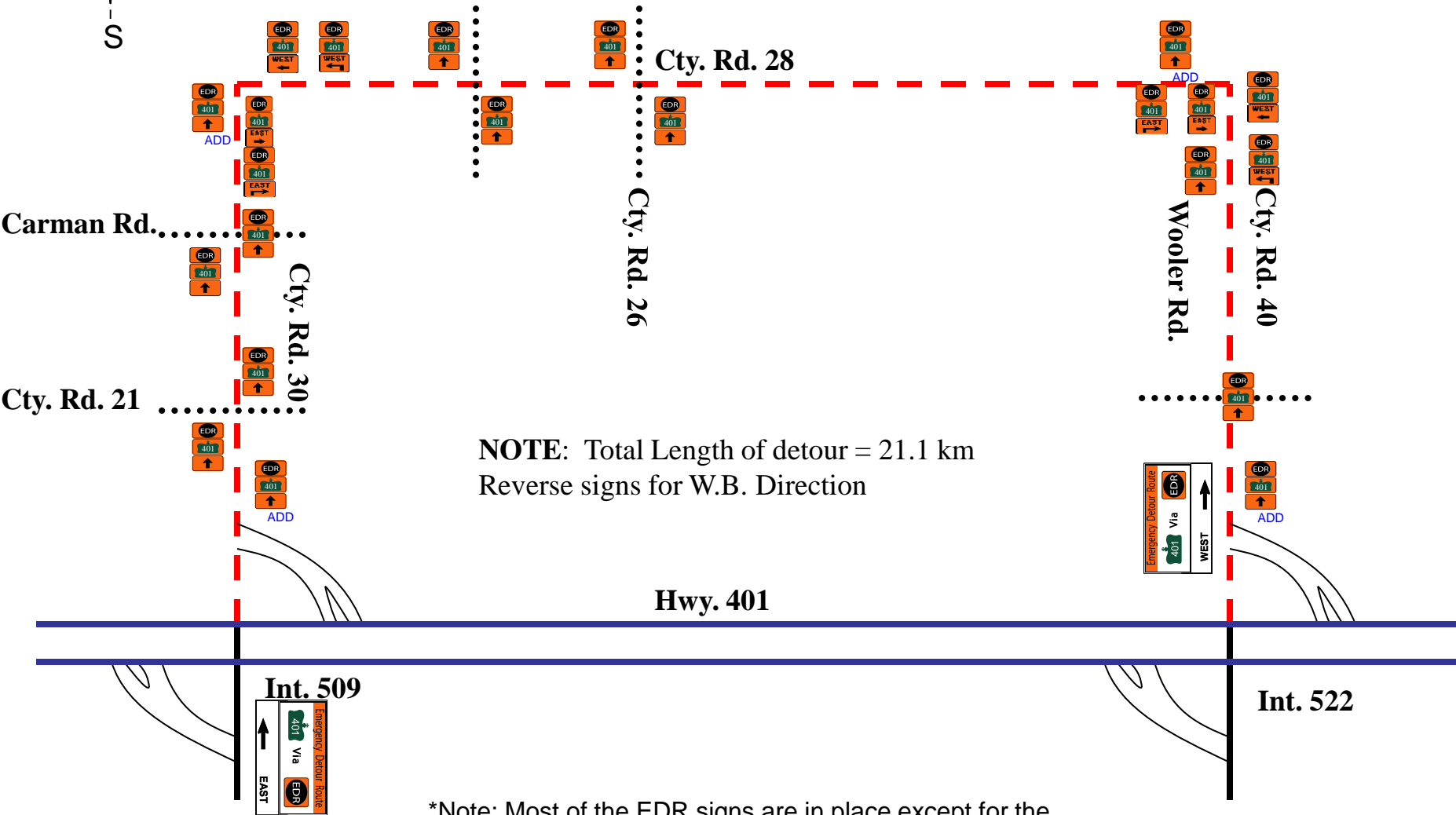
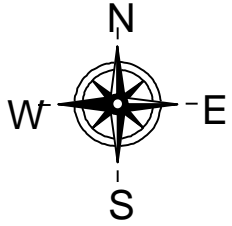

**NOTE:** Total Length of detour = 21.1 km  
Reverse signs for W.B. Direction

\*Note: Most of the EDR signs are in place except for the ones which have the word "ADD" underneath